



SPECIAL CITY COUNCIL MEETING ~ 7:00PM

AGENDA

Commented [KT1]: EN

WEDNESDAY, JULY 13, 2022

LOCATION:

**City Meeting Room
(former Wiley Middle School Library
next door to Board of Education)
2181 Miramar Blvd.
University Heights, Ohio**

Per current CDC guidelines face coverings are no longer required.

NOTE: Executive Session may follow meeting to discuss legal, personnel and real estate matters.
(Motion Required)

1. Roll Call
2. Agenda Items:
 - A. Motion to Approve Planning Commission's Recommendation of Approval from July 7, 2022 regarding Application from John Carroll University for Traffic & Parking Presentation for Site Plan Approval
 - B. Motion to Approve the Economic Development Committee motion to Create the Zoning Committee, a subcommittee of the Economic Development Committee
 - C. Discussion on the Progress of the RRS Rubbish Survey
3. Adjournment



TO: Mayor Brennan and Members of City Council
FROM: Kelly M. Thomas, Clerk of Council
DATE: July 10, 2022
RE: Planning Commission Decision

At its regular meeting held on Thursday, July 7, 2022, the Planning Commission made the following motions to be approved by City Council.

A. Application from John Carroll University

- 1. Traffic & Parking Presentation for Site Plan Approval**
- 2. Field House Presentation for Preliminary Review**

MOTION BY MAYOR BRENNAN, SECONDED BY MRS. URBAN to Recommend to City Council the approval of the closure of the South Belvoir parking lot John Carroll University and the approval of the proposed means of ingress and egress on campus as set forth in the presentation. Together with the temporary parking lot plan contingent upon of the execution of the contracts between John Carroll University and Jewish Family Experience and Notre Dame for the 200 parking spaces between those two institutions. On roll call, all voted “aye.”

###



John Carroll University **Parking and Traffic Updates**

7 July 2022



Parking Requirements

Students

Projected Undergraduates
2,400 Students

Projected Graduate Students
400 Students

Total Projected Students
2,800 Students

Total @ 4 Students/Space:
700 Spaces

JCU Employees

Faculty/Staff/Grad Assistants
710

90% Attendance Factor
639

Total = 639/1.25 per person
511 Spaces

Total Parking Required
1,211 Spaces



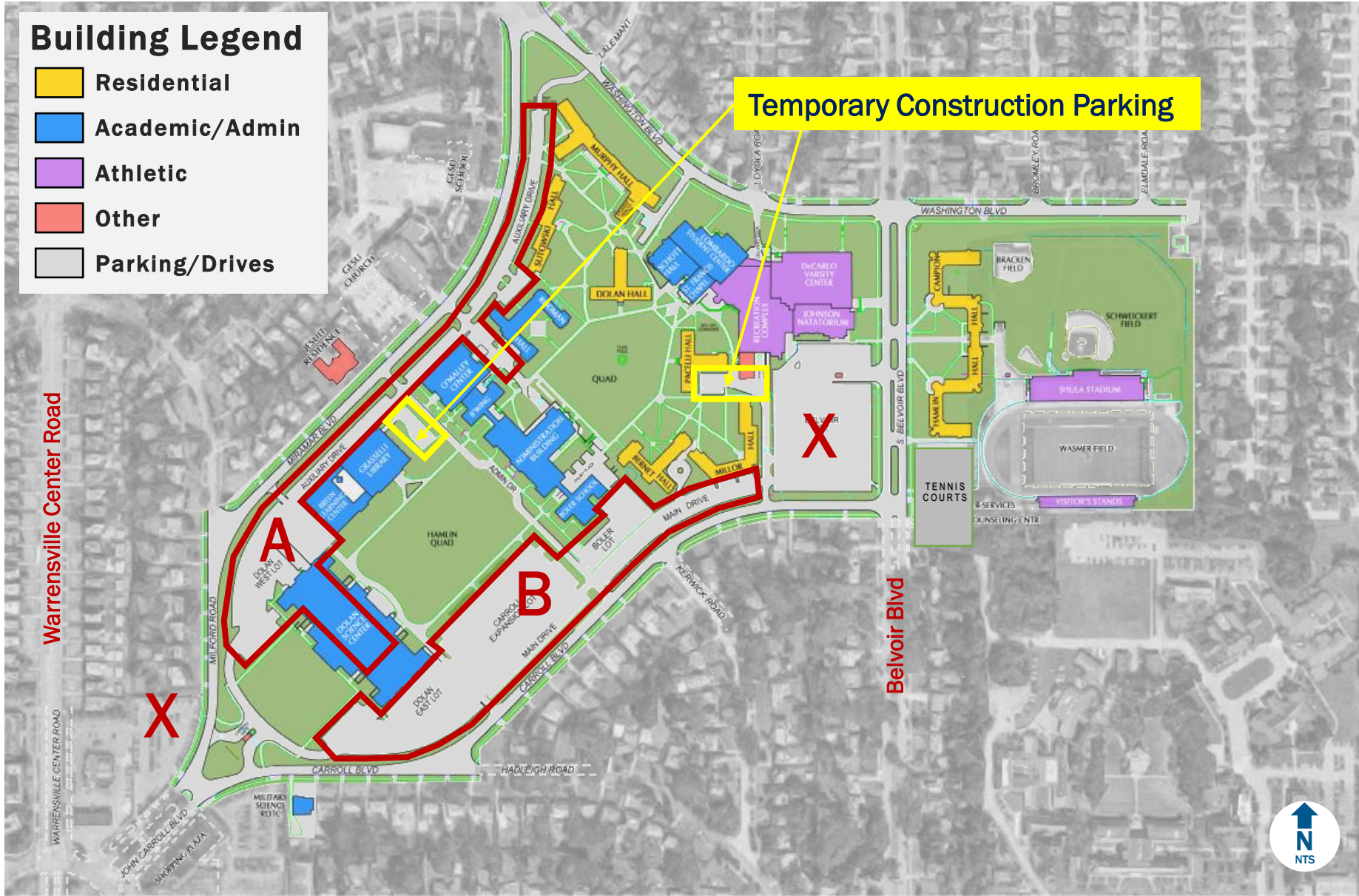

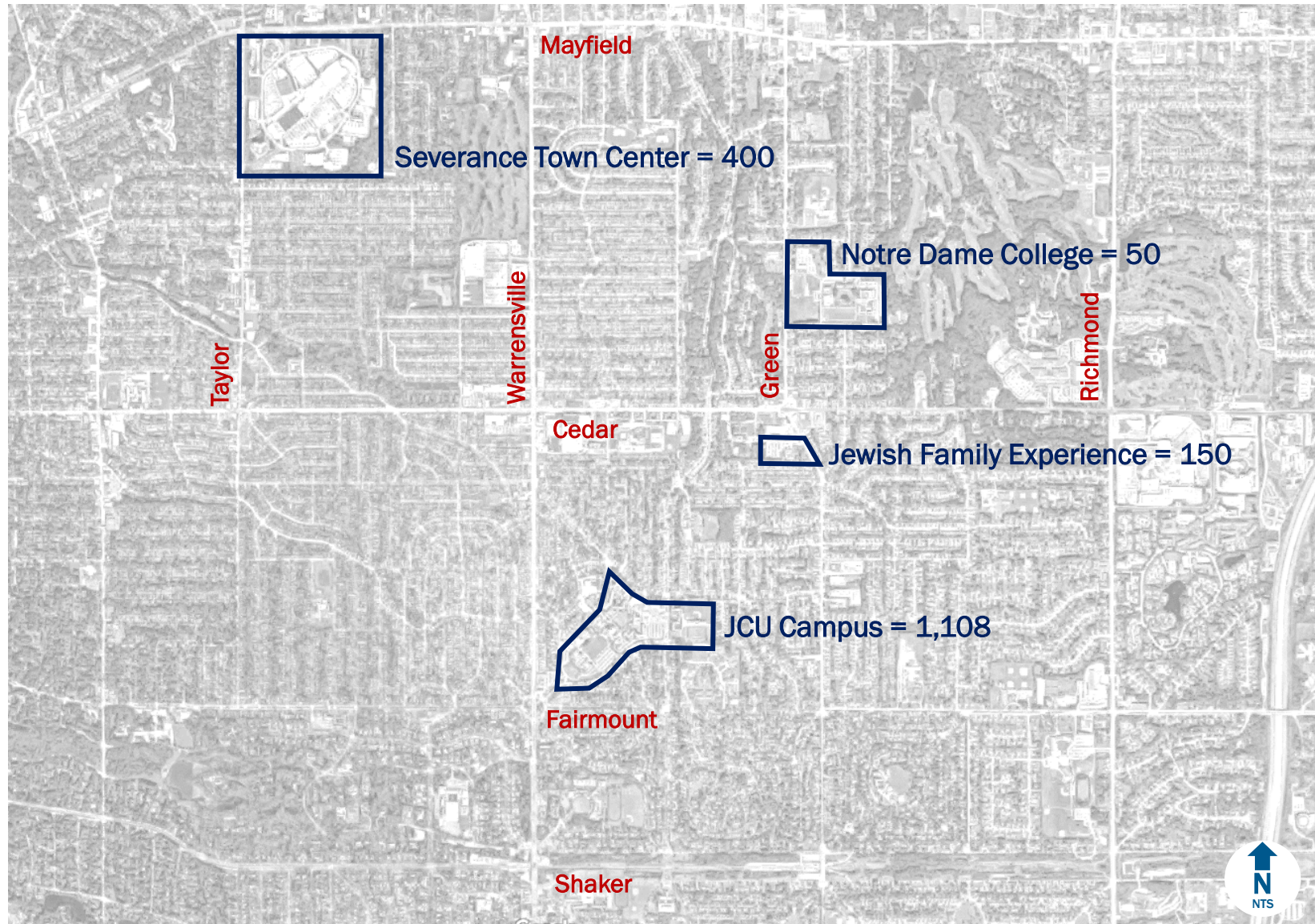

Off-Campus Temp Parking:

Jewish Family Experience

150 JCU Spaces

Notre Dame College

50 JCU Spaces

+ Temp JCU On-Campus Total

1,108 Spaces

Temporary Parking Total:

1,308 Spaces

Parking for Contractors:

Severance Town Center

400 Spaces

Total Parking Required

1,211 Spaces

*** 97 Spaces Surplus**



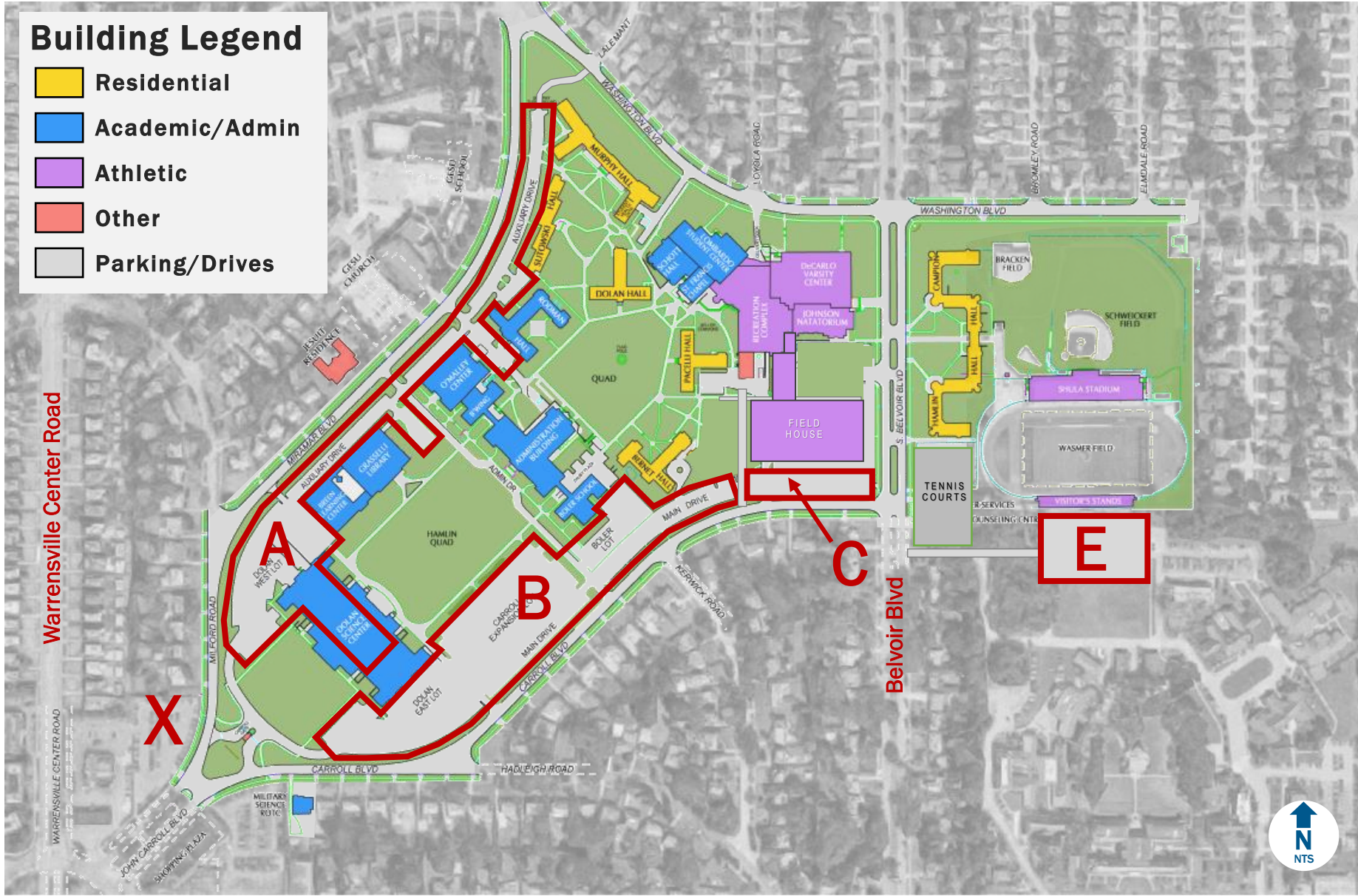

Future Campus Parking:

- A) North @ Auxiliary Drive
395 Spaces
- B) South @ Main Drive
717 Spaces
- C) Future Field House Lot
60 Spaces
- D) Commuter Lot
0 Spaces
- E) Proposed Parking Garage
525 Spaces

**Future Parking Total:
1,697 Spaces**

**Total Parking Required
1,211 Spaces**

*** 486 Spaces Surplus**





Building Legend

- Residential
- Academic/Admin
- Athletic
- Other
- Parking/Drives

Existing Campus Access:

○
Emergency/Fire Access Only @
Miramar, Washington, Carroll

○ ●
JCU Staff + Fire Lane @
Murphy from Washington

○
JCU Staff Access Only @
RecPlex from Washington

○
A) Open Entrance/Exit @
John Carroll Blvd

○
B) Open Entrance/Exit @
Belvoir Blvd



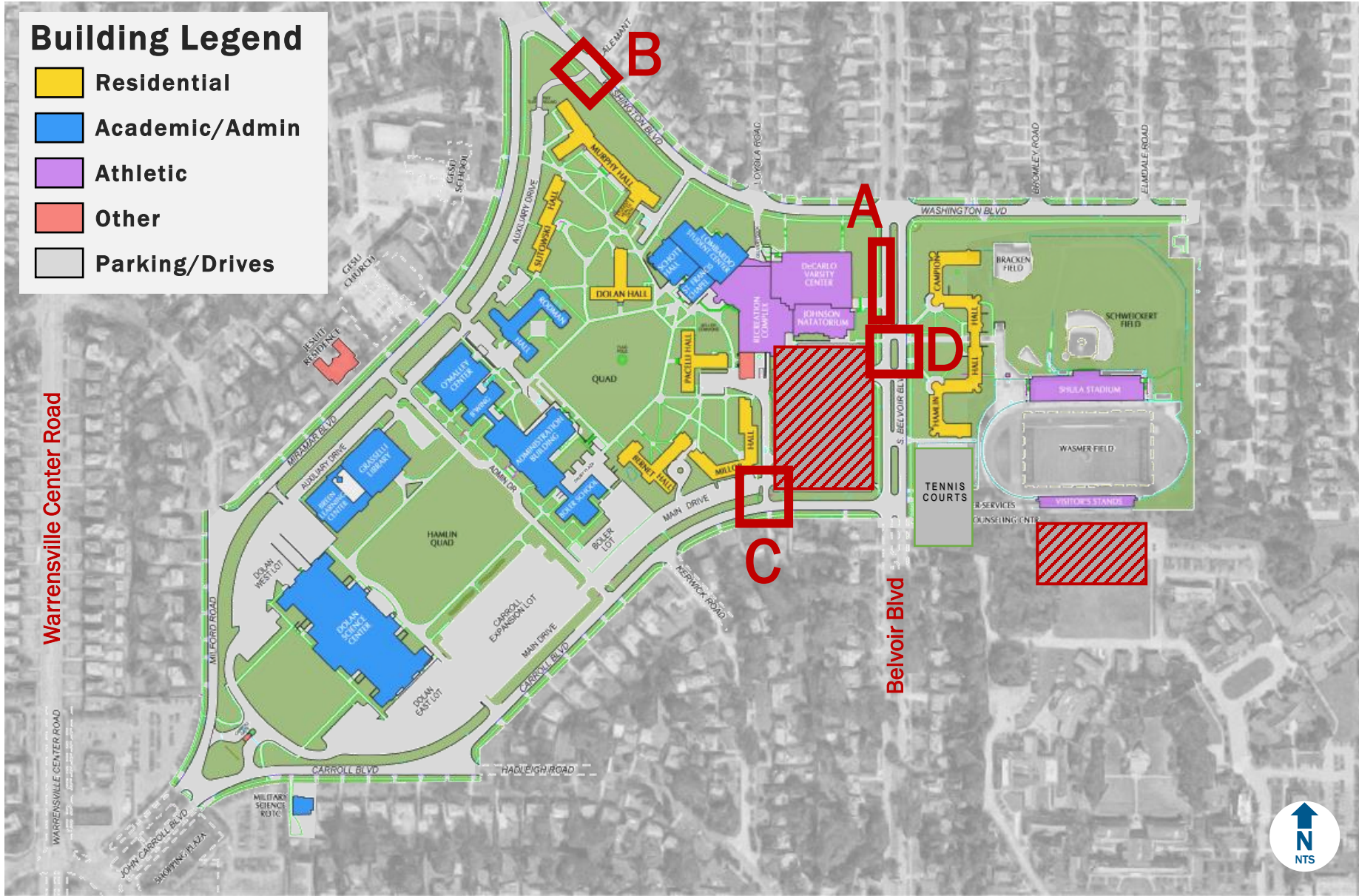

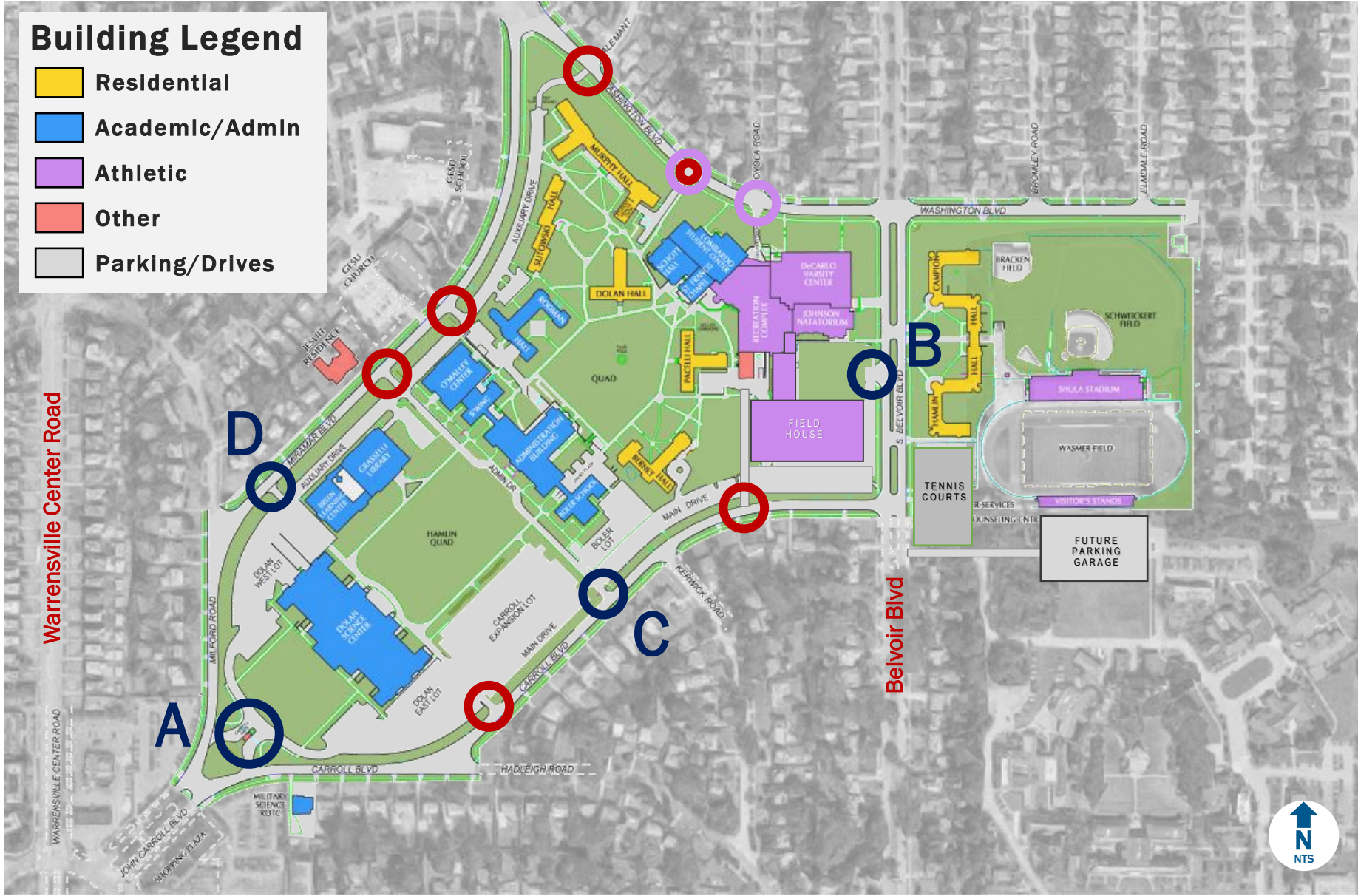

Existing Campus Access:

Emergency/Fire Access Only @ Miramar, Washington, Carroll

JCU Staff + Fire Lane @ Murphy from Washington

JCU Staff Access Only @ RecPlex from Washington

- A) Open Entrance/Exit @ John Carroll Blvd
- B) Open Entrance/Exit @ Belvoir Blvd
- C) Open Entrance/Exit @ Carroll Blvd/Admin Dr.
- D) Open Entrance/Exit @ Dolan Lot W/Auxiliary Dr.





John Carroll University **Field House Concept Design**

7 July 2022

Existing Campus Map + Proposed Field House Site



Field House Summary

- New 200 Meter Track in 63,000 SF space
- Connect to existing Recreation Complex
- Targeted interior renovations
- Occupy Belvoir Lot and Millor Hall sites
- Millor Hall demolition 2023
- Maintain pedestrian connection from east side of Belvoir through to main campus



Future Campus Map + Proposed Field House

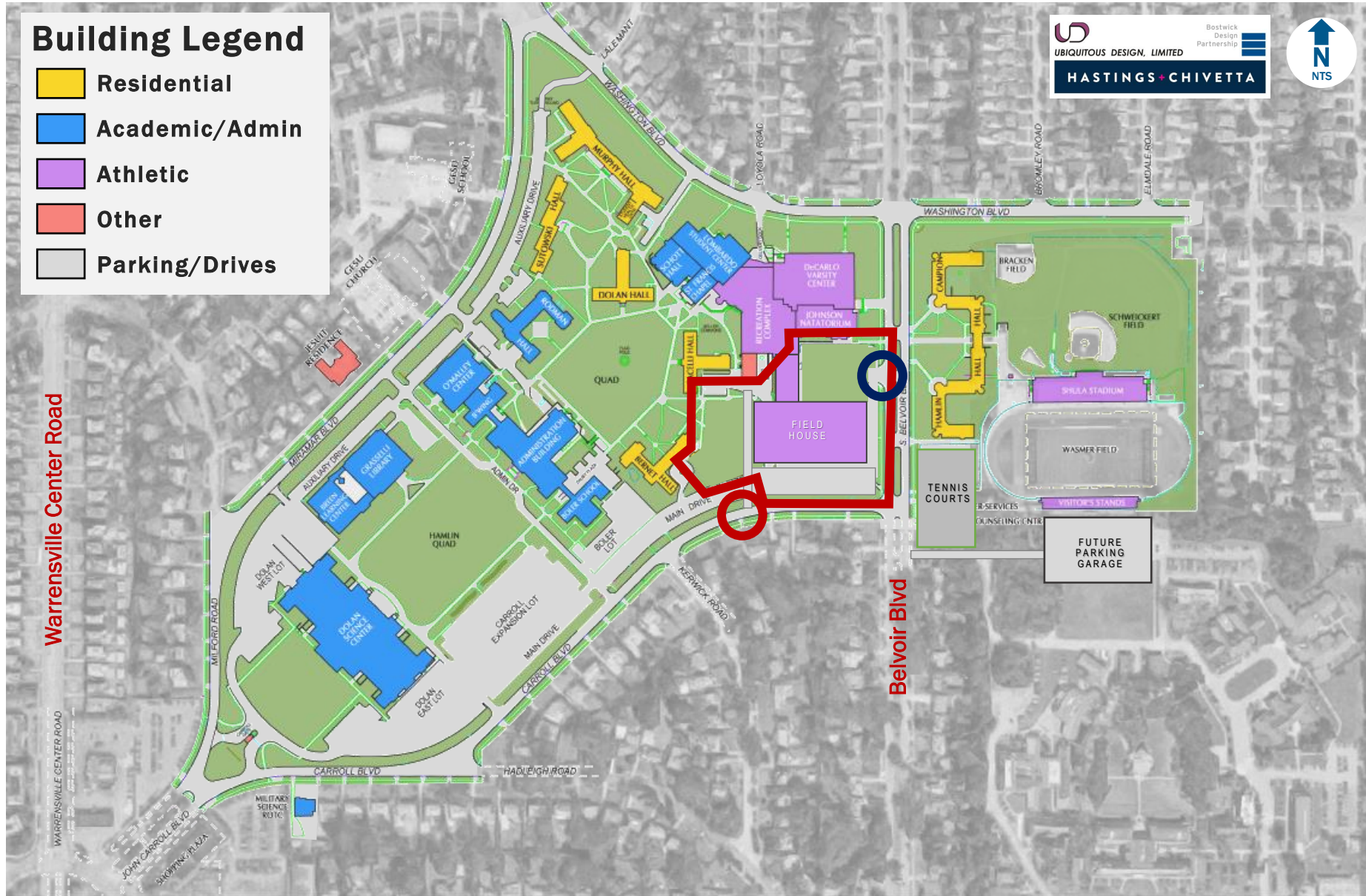

Building Legend

- Residential
- Academic/Admin
- Athletic
- Other
- Parking/Drives

- Existing Campus Access:**
- Emergency/Fire/JCU Staff Access Only @ Carroll Blvd
 - Re-open Entrance/Exit @ Belvoir Blvd at Field House



Future Campus at Proposed Field House - Conceptual Site Plan

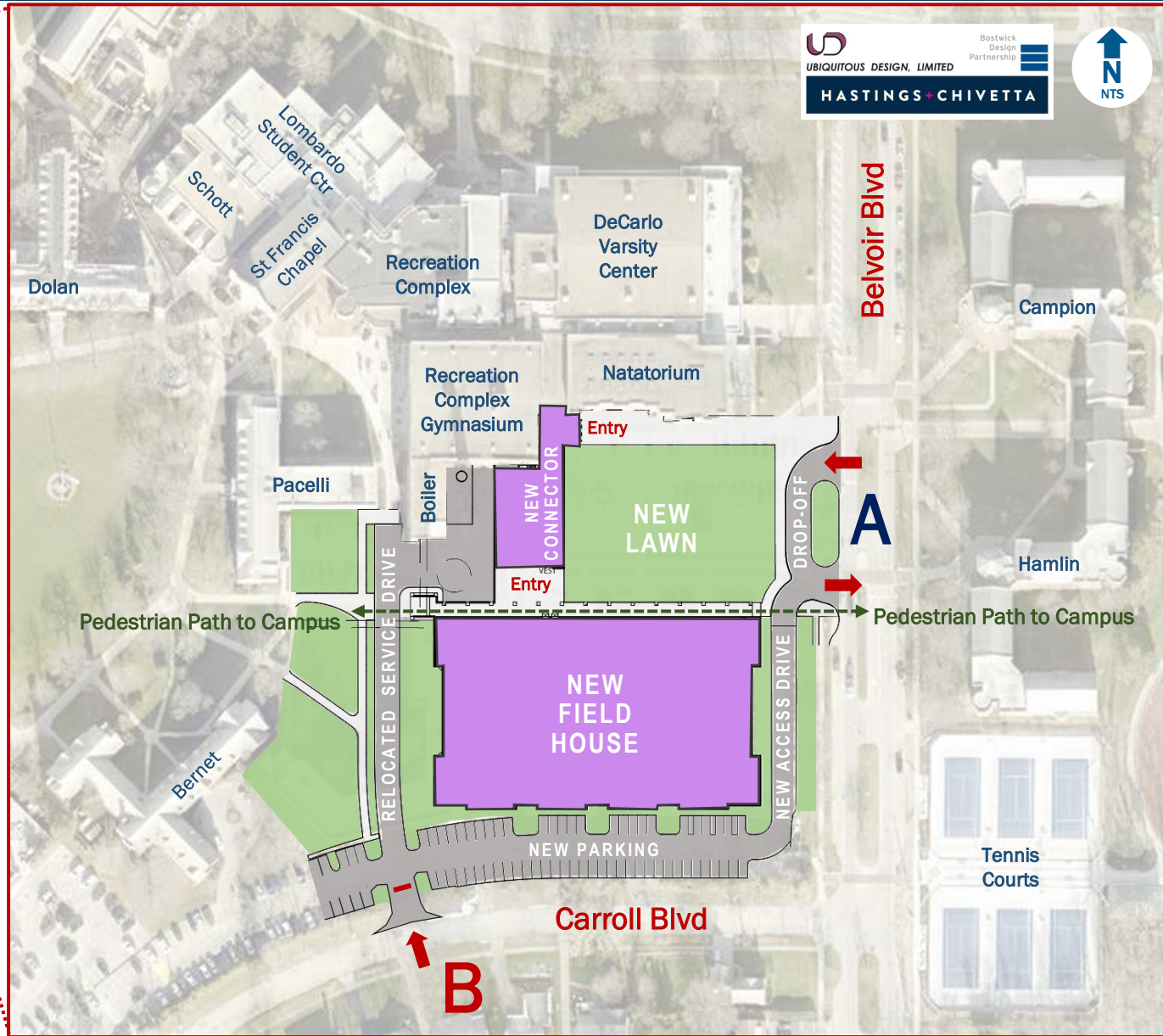

Field House Summary

- New 200 Meter Track in 63,000 SF space
- Connect to existing Recreation Complex
- Targeted interior renovations
- Occupy Belvoir Lot and Millor Hall sites
- Millor Hall demolition 2023
- Maintain pedestrian connection from east side of Belvoir through to main campus

A. Re-open Entrance/Exit @ Belvoir Blvd at Field House

B. Emergency/Fire/JCU Staff Access Only @ Carroll Blvd



Proposed Field House - Conceptual Massing + View from Northeast

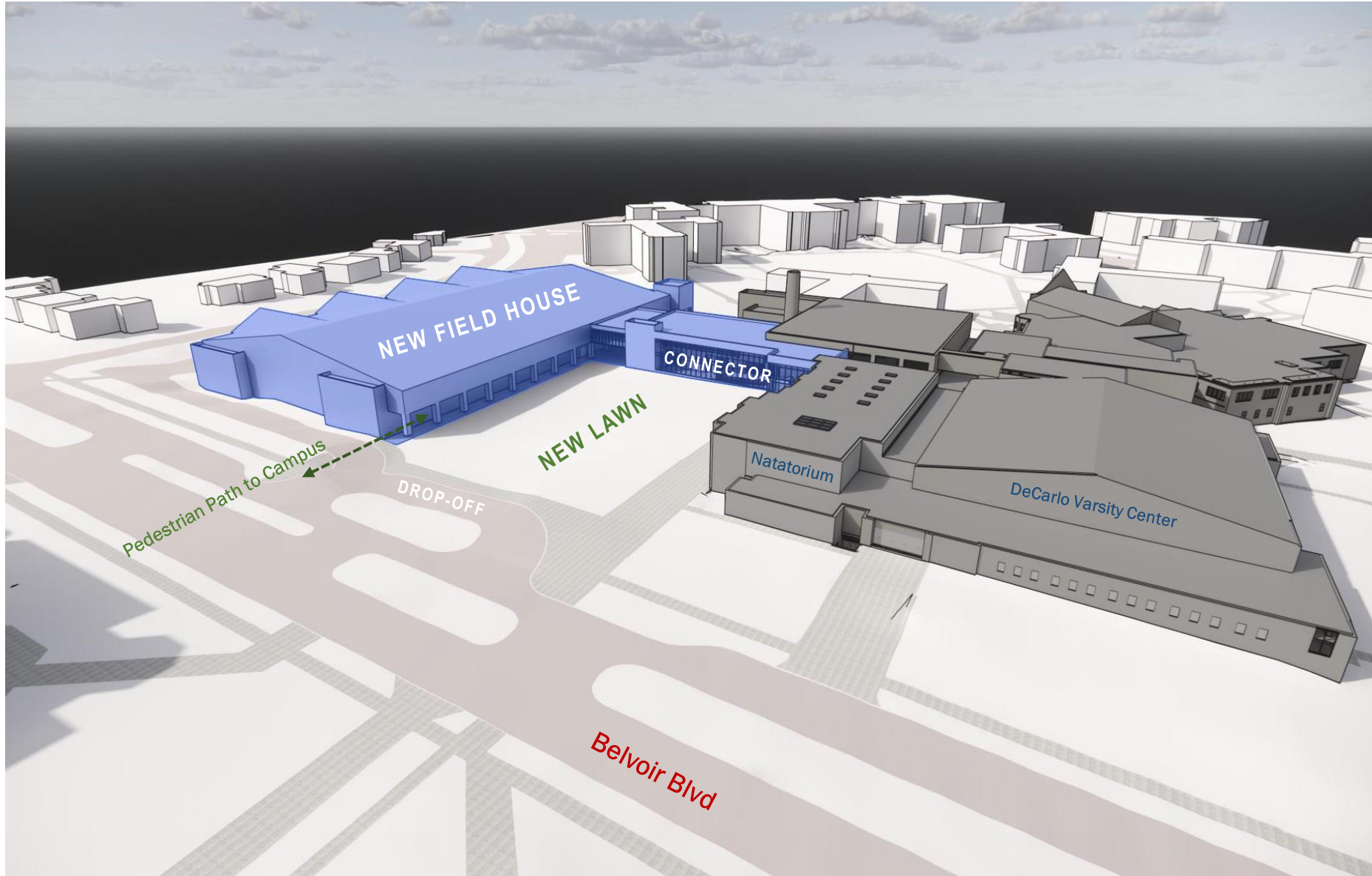

Proposed Field House - Conceptual Massing + View from Southeast



Proposed Field House - Conceptual Massing + View from Southwest

